

Jelly Fish Instructions & Pattern



Print the pattern on the next page of this document. Cut out roughly then attach to your fabric/felt with stick pins. We used fabric for the body and thick felt for the rest.



Carefully cut out along the pattern lines.



Assemble your jelly fish pieces: bottom body first, then the tentacles. Last put on the top of the body on. The stick pins will hold the jelly fish together while you sew. Leave an opening to stuff.



Use polyester filling to stuff the body of your jelly fish.

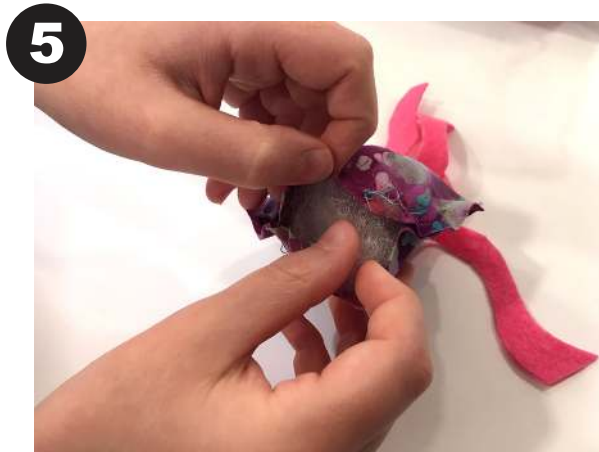

Stuff the jelly fish then sew up the opening.



Use craft glue to glue on googly eyes.

Jelly Fish
Instructions & Pattern

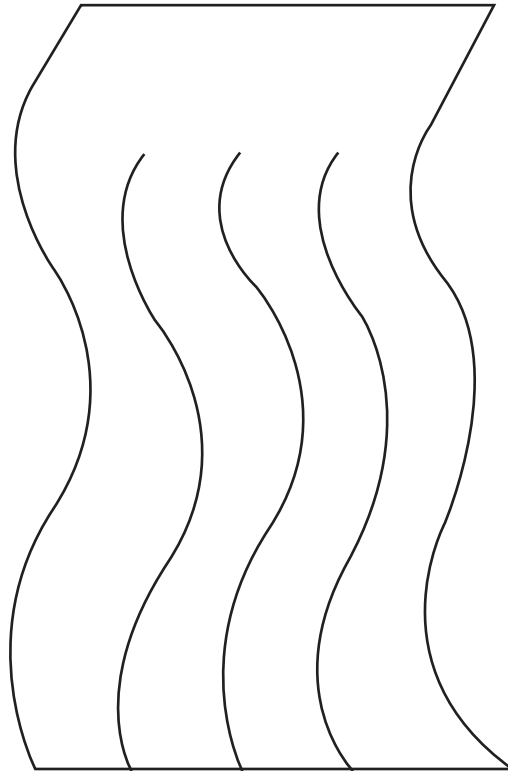

Print this page at
100% size
(actual size)

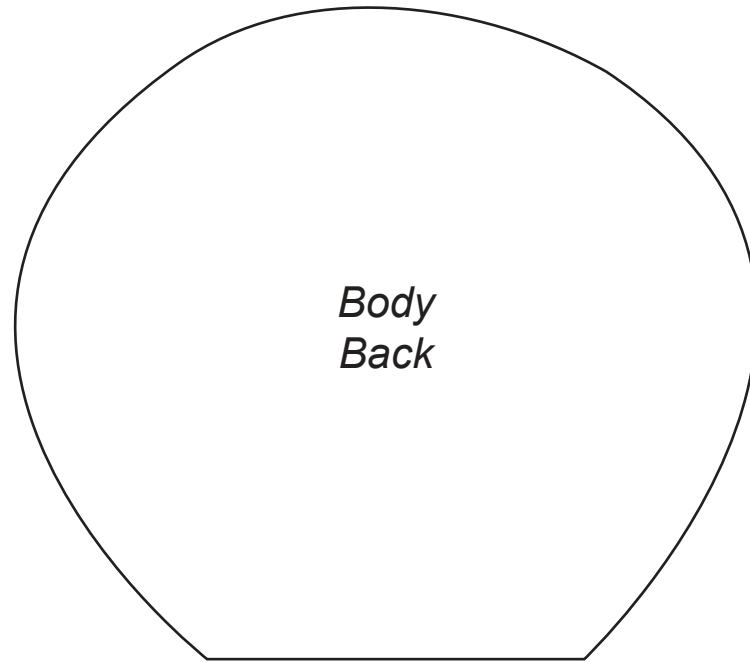

*Body
Back*

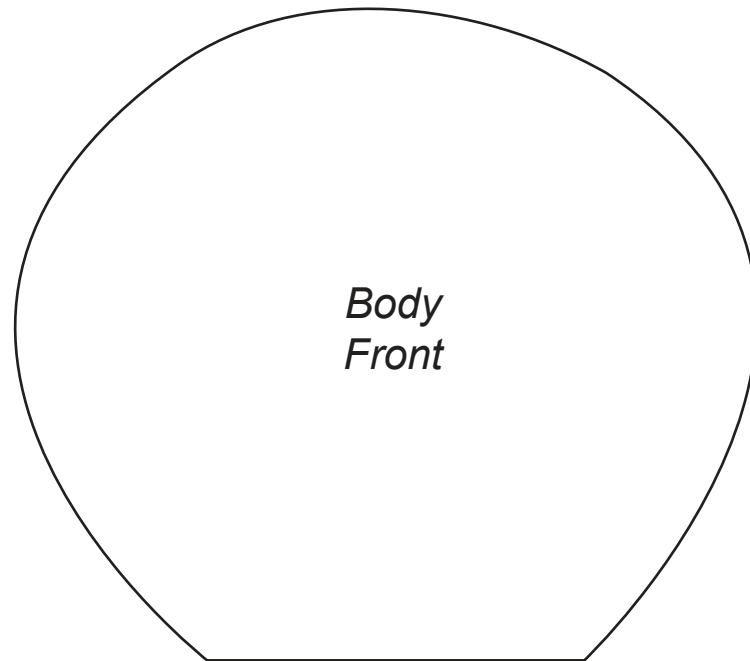

*Body
Front*